

HANGING WHITEBOARDS

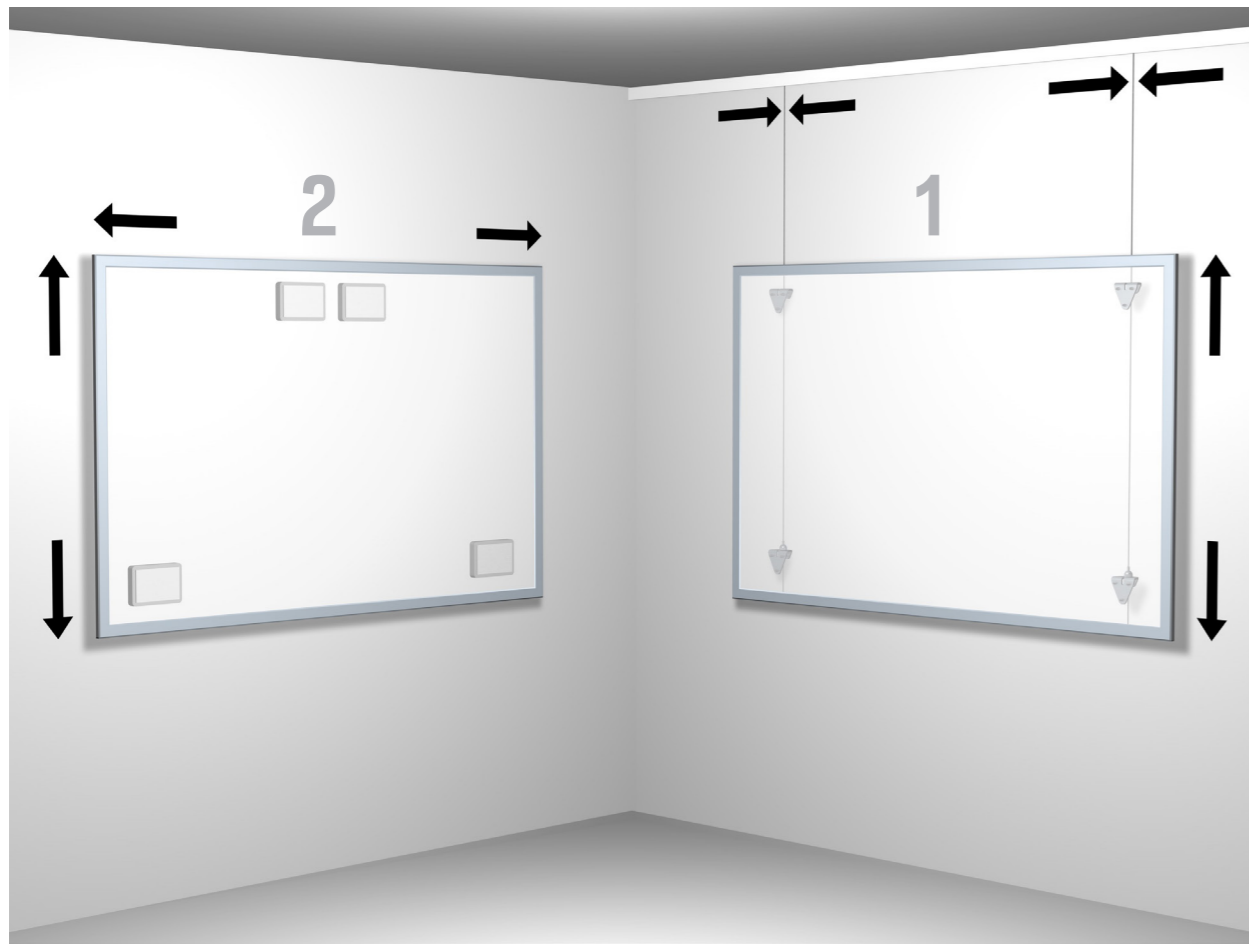

There are a variety of ways to hang a whiteboard on the wall. Hanging a whiteboard with the aid of the Whiteboardset offers the option of repositioning the whiteboard either horizontally or vertically. The Artiteq Whiteboardset has been designed to make it easy to hang a whiteboard on the wall, and offers flexibility since it may be used in combination with our hanging rails. The clamps ensure a stable mounting of the whiteboard to the wall. By combining the Whiteboardset with the hanging rail, it is extremely easy to mount the whiteboard to the precise desired spot.

WHITEBOARDSET / HANGING MAGNET FOR WHITEBOARDS

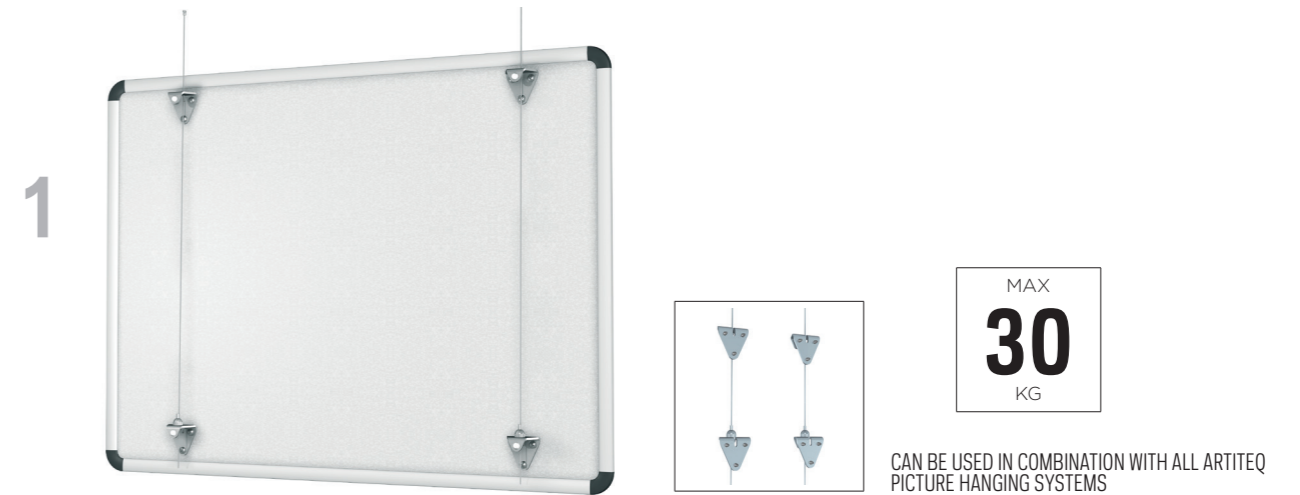

WHITEBOARDSET				
WHITEBOARDSET (HANGING WIRE NOT INCLUDED)*	2x KLEM UP	2x KLEM DOWN	12x SCHROEF 8 mm	12x SCHROEF 12 mm
ARTICLE NO. 9.4550				

* TO BE USED WITH TWISTER 2 mm STEELWIRE (SEE PAGE 57)

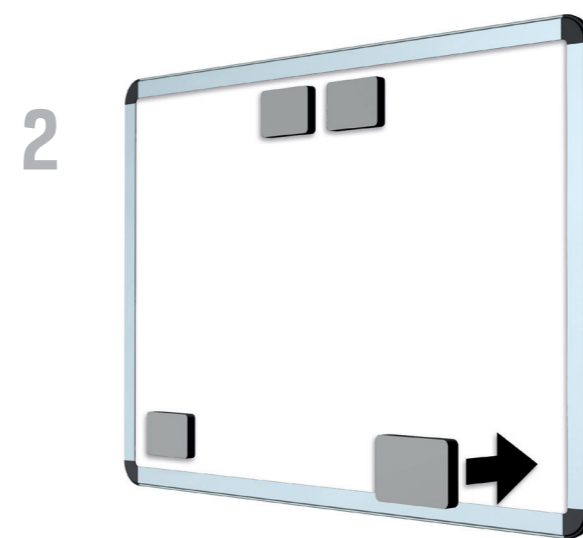

SELF-ADHESIVE HANGING MAGNET FOR WHITEBOARDS			
7430.001	SELF-ADHESIVE HANGING MAGNET FOR WHITEBOARDS	75 x 50 x 11 mm	MAX. 3 kg